



**THIS BOOKLET COVERS PRODUCT CODES:**

**ARM CTRD01 C  
ARM CTRD02 C  
ARM WARD01 C  
ARM WASQ01 C**

## **Shower Arm**

## **Fitting Instructions**

TELEPHONE HELPLINE: 0844 701 6273

Bristan Group Limited  
Birch Coppice Business Park  
Dordon  
Tamworth  
Staffordshire  
B78 1SG  
UK

A Masco Company

Website: [www.bristan.com](http://www.bristan.com)  
Telephone: 0844 701 6274  
Facsimile: 0844 701 6275  
Email: [enquire@bristan.com](mailto:enquire@bristan.com)

(FI ARM CT\_WA)

(REV D2)

**Please keep these instructions for future reference**

This shower arm is intended to be used in conjunction with other products, such as shower or blending valves, diverters and stopcocks from the Bristan ranges in order to create a system to suit your requirements.

## **COMPONENTS**

1. Backnut
2. Locknut
3. Shroud
4. Shower Arm\*

## **INSTALLATION**

The shower arm should be arranged to accept a supply of flow controllable mixed water.

1. Identify all components and check for completeness before arranging fitting.
2. The shower arm (4\*) should be secured using the backnut (1) and the locknut (2) (where supplied).
3. Rigid pipework should be used to support the arm, via a female G 1/2" BSP to a 15/22mm compression adaptor, (not supplied).

**NOTE:** Before finishing ceiling, turn on water to supplies to check for leaks at connections.

4. Connect arm to supply using thread sealing compound where necessary.
5. Complete wall finish and slide shroud (3) up to ceiling.

## **INSTALLATION DIAGRAM**

\* Design & Dimensions of the shower arm may vary to that shown.

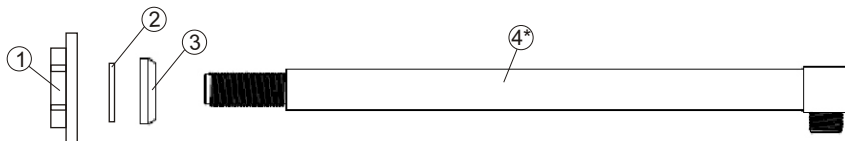

## **AFTERCARE INSTRUCTIONS**

Your fitting has a high quality finish and should be treated with care to preserve the visible surfaces.

All surface finishes will wear if not cleaned correctly, the only safe way to clean your mixer is to wipe with a soft damp cloth. Stains can be removed using washing up liquid. All bath cleaning powders and liquids will damage the surface of your fitting, even the non-scratch cleaners.

**NOTE: Never use abrasive detergents or disinfectants or those containing alcohol, hydrochloric acid or phosphoric acid.**

Bristan recommend E-Cloth for cleaning all of our bathroom & kitchen products. Using just water, E-cloth gives a smear free, deep clean by breaking up and holding dirt, which normal cloths leave behind. Order through your Bristan stockist. (ORDER CODE: ECLOTH)



## **GUARANTEE**

All products are manufactured to the highest standards and a 5 year guarantee covers any defect in manufacture.

**All products must have access for servicing or replacement during the life of the product.**

In the interests of continuous product development we reserve the right to alter specification as necessary